

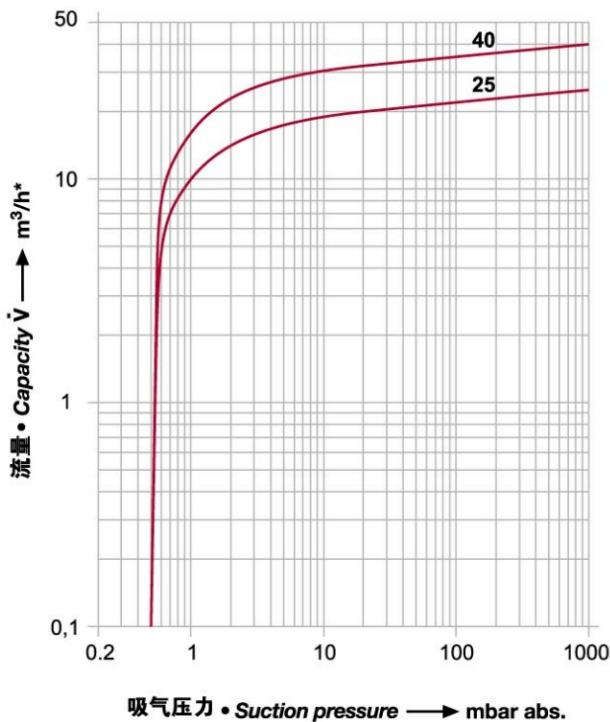

油润滑旋片式真空泵。流量从25至48 m³/hr，极限真空0.5 mbar(绝对值)。法兰式电机，转子两侧装有轴承，风冷式。内置筛网过滤器，真空逆止阀，气镇阀和油分离器。
法兰式电机符合 DIN EN 60034 标准，保护标准 IP 54，绝缘等级 F。

Oil flooded rotary vane vacuum pump with capacities ranging from 25 to 48 m³/hr. Ultimate vacuum 0.5 mbar (abs.). Flange motor, bearings on both sides of the rotor, air cooling. Fitted as standard with fine mesh filter, vacuum non-return valve, gas ballast valve and oil separator.
Flange mounted motors comply with DIN EN 60034, have IP 54 protection and insulation class F.

50 Hz 选型图 • Selection diagram



60 Hz 选型图 • Selection diagram

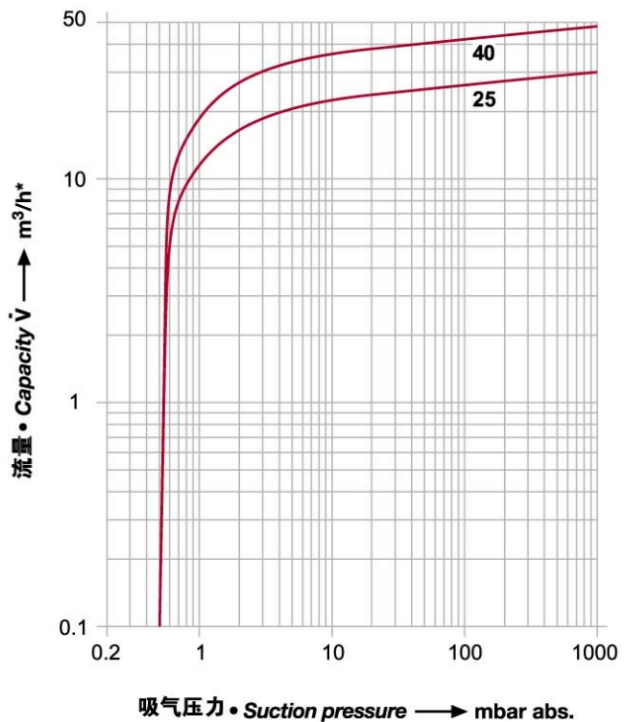

| VCA | | 25 | | 40 | |
|-----------------------------|---------------------|---------|-------------------|-------|-----------|
| 流量 Capacity | m ³ /h | 50 Hz | 25 | 60 Hz | 30 |
| 极限真空 Ultimate vacuum | mbar (abs.) | 0,5 | | | |
| 电机类型 Motor version | 3~ | 50 Hz | 230 / 400V ± 10 % | | |
| | | 60 Hz | 220 / 380V | | |
| | 1~ | 50 Hz | 230V ± 10 % | | |
| | | 60 Hz | 220V | | |
| 电机功率 Motor rating | kW (3~) | 50 Hz | 0,75 | | 1,1 |
| | | 60 Hz | 0,90 | | 1,3 |
| | kW (1~) | 50 Hz | 1,0 | | 1,5 |
| | | 60 Hz | 1,3 | | 1,8 |
| 电流 Current drawn | A (3~) | 50 Hz | 3,5 / 2,0 | | 4,7 / 2,7 |
| | | 60 Hz | # | | # |
| | A (1~) | 50 Hz | 7,2 | | 9,0 |
| | | 60 Hz | 10,9 | | # |
| 转速 Speed | min ⁻¹ | 50 Hz | 1450 | | |
| | | 60 Hz | 1740 | | |
| 平均噪音 Average noise level | dB(A) → DIN45635 | 50 Hz | 57 | | 61 |
| | | 60 Hz | 59 | | 63 |
| 最大重量 Maximum weight | kg | 3~ / 1~ | 40 / 45 | | 50 / 53 |
| 油量 Oil capacity | l | | 1 | | 2 |

附件 • Accessories

| VCA | | | 25 | 40 |
|---|-----|------------|----------|-------------------|
| 逆止阀 Non-return valve | ZRK | | 20 (03) | 25 (03) |
| 真空密封灰尘分离器 Dust separator, vacuum tight | ZFP | | 145 (11) | 145 (06) |
| 真空密封进气口过滤器 Vacuum tight suction filter | ZVF | 50 / 60 Hz | 20 (53) | 20 (54) / 32 (52) |
| 电机启动器 Motor starter | ZMS | | # | # |

尺寸 • Dimensions [mm]

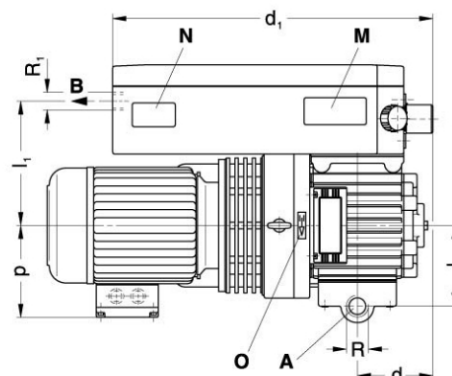
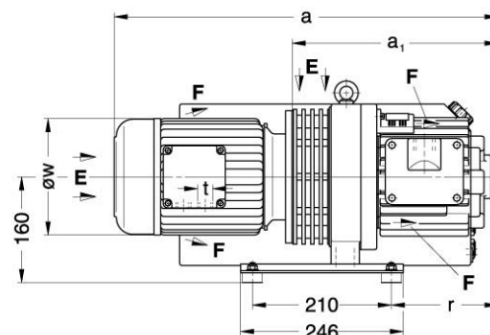
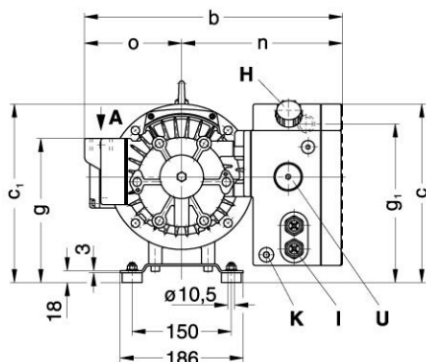

| VCA | 25 | 40 |
|----------------|------------|------------|
| a 3~ | 462 | 510 |
| 1~ | 512 | 573 |
| a ₁ | 230 | 266 |
| b | 333 | 380 |
| c | 255 | 270 |
| c ₁ | 270 | 270 |
| d | 70 | 89 |
| d ₁ | 360 | 411 |
| g | 218 | 218 |
| g ₁ | 221 | 235 |
| l | 105 | 111 |
| l ₁ | 145 | 188 |
| n | 201 | 243 |
| o | 132 | 137 |
| p | 139 | 139 |
| r | 80 | 116 |
| t | M 20 x 1,5 | M 25 x 1,5 |
| øw | 176 | 176 |
| R | G ¾ | G 1 |
| R ₁ | Rp ½ | Rp ¾ |

| | |
|---|-----------------------------|
| A | 真空联接处 Vacuum connection |
| B | 排气口 Exhaust |
| E | 冷却空气入口 Cooling air entry |
| F | 冷却空气出口 Cooling air exit |
| H | 注油口 Oil filling point |
| I | 油位镜 Oil check |

| | |
|---|-------------------------------|
| K | 排油口 Oil drain point |
| M | 油标牌 Oil type plate |
| N | 数据牌 Data plate |
| O | 旋转方向 Direction of rotation |
| R | 油冷却器 Oil cooler |
| U | 气镇阀 Gas ballast valve |

*与进气口联接的吸气状态有关。工作曲线和数据表是按PNEUROP标准计算的，其所示为真空泵在正常温度下运行。我们保留调整技术数据权利。尺寸a, p和øw或和电流值会因不同电机而与数据表不同。水气容纳，见数据I 200。
根据需要

* refers to suction conditions at inlet connection. Curves and tables calculated according to PNEUROP standards and refer to vacuum pump at normal operating temperature. The dimensions a, p and øw and /or the current drawn can differ.
Water vapour tolerance, see information I 200.
on request